

## Fontaine Fifth Wheel Cylinder Valve Replacement

Air actuated Fontaine Fifth Wheel models feature an air cylinder for cab release. **It is very important that a cylinder valve is functioning properly, especially in cold weather.**

A kit is available for cylinder component repair or retrofitting. Part number (Left Driver Side Handle): **KIT-AA-6000L**.

However, sometimes you may need to replace just the valve. Fontaine recommends using the Clippard **JEV-F4M4** or equivalent. This part is readily available at multiple parts distribution stores. The exhaust valves can also be ordered through Fontaine part number **KIT-AA-VLV** which contains 5 exhaust valves. See valve specs below.

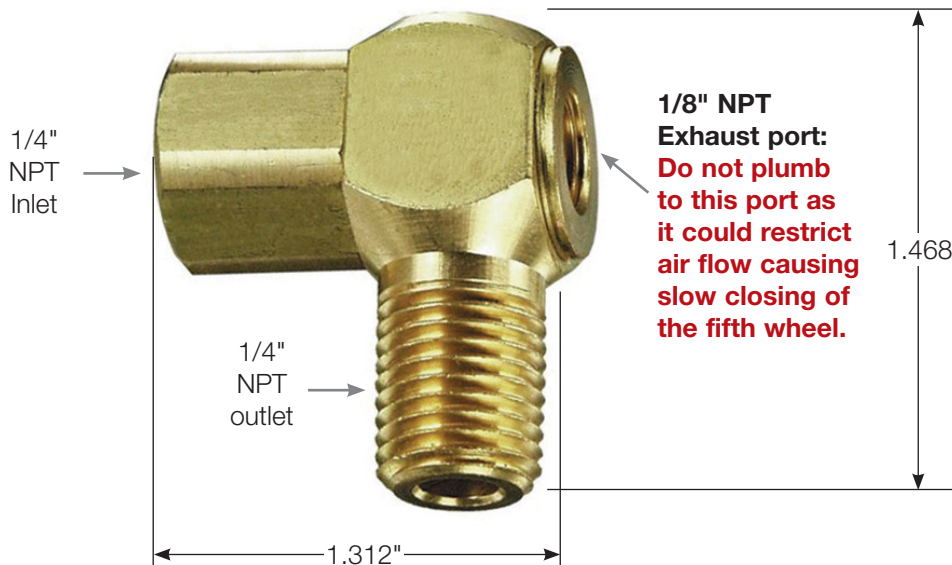

- 15 to 150 psig maximum
- Male outlet offers direct connection to cylinder
- 36 scfm @ 50 psig and 58 scfm @ 100 psig
- Brass construction with molded Nitrile seal

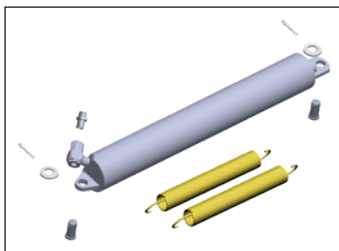

No-Slack® **KIT-AA-6000L** currently includes the JEV-F4M4 valve.



**KIT-AA-VLV** Fontaine kit contains 5 exhaust valves.